

CITY OF WOONSOCKET
169 MAIN STREET
WOONSOCKET, RI 02895
401-767-9269
401-597-6604 Fax

TO: ALL BIDDERS
FROM: Jonathan R. Pratt, P.E., City Engineer
DATE: May 22, 2017
SUBJECT: Replacement of Operations Building Roof
– Bid# 5800

ADDENDUM #2

Please note that the Bid Due Date and Opening has been changed to Wednesday, May 31, 2017 at 2:00 PM at the Woonsocket City Hall, 169 Main St., Woonsocket, RI 02895

For further information, please contact:
Jessica L Desrochers at (401) 767-9269 or email:

jdesrochers@woonsocketri.org

ANSWERS TO QUESTIONS FROM THE PRE-BID MEETING ON MAY 18, 2017

Q: How will the lightning protection be addressed?

The contractor is responsible for hiring a subcontractor to recertify the repaired and reinstalled assembly.

Q: How will the chimney be capped?

The existing chimney is to remain and the demolition of the chimney is to be removed from the scope. CH2M Hill has informed the City that they are utilizing one of the flues. The contractor is to provide repair of all deteriorated mortar and suitable flashing to ensure a watertight condition.

Q: Is the core composition available?

See the core composition detailed in the attached document.

Q: How will the structural decking be infilled after removing the obsolete HVAC RTU?

The existing curb is to remain in place. The contractor will attach ¾" plywood over the curb with an appropriate type and number of fasteners and fabricate and install a .040 aluminum cap.

Q: Will a tapered insulation plan be provided?

The contractor is responsible for providing a tapered insulation plan to be submitted for approval. A base layer of R25 is required. The concrete deck is believed to be structurally sloped at 1/8". The tapered insulation should be designed to achieve ¼" total slope.

Measurements are to be confirmed by the contractor.

Q: How will the wall flashing be addressed on the connector roof?

The thru-wall counter-flashing is to be raised to meet the new insulation heights and achieve an 8" minimum flashing height.

Q: How will the expansion joint detail be addressed at the transition between the BUR and TPO roof assemblies?

The contractor is to remove the existing termination bar, install the new 2 ply flashing system, terminate flashing plies, and install a new aluminum expansion joint cover over the transition.

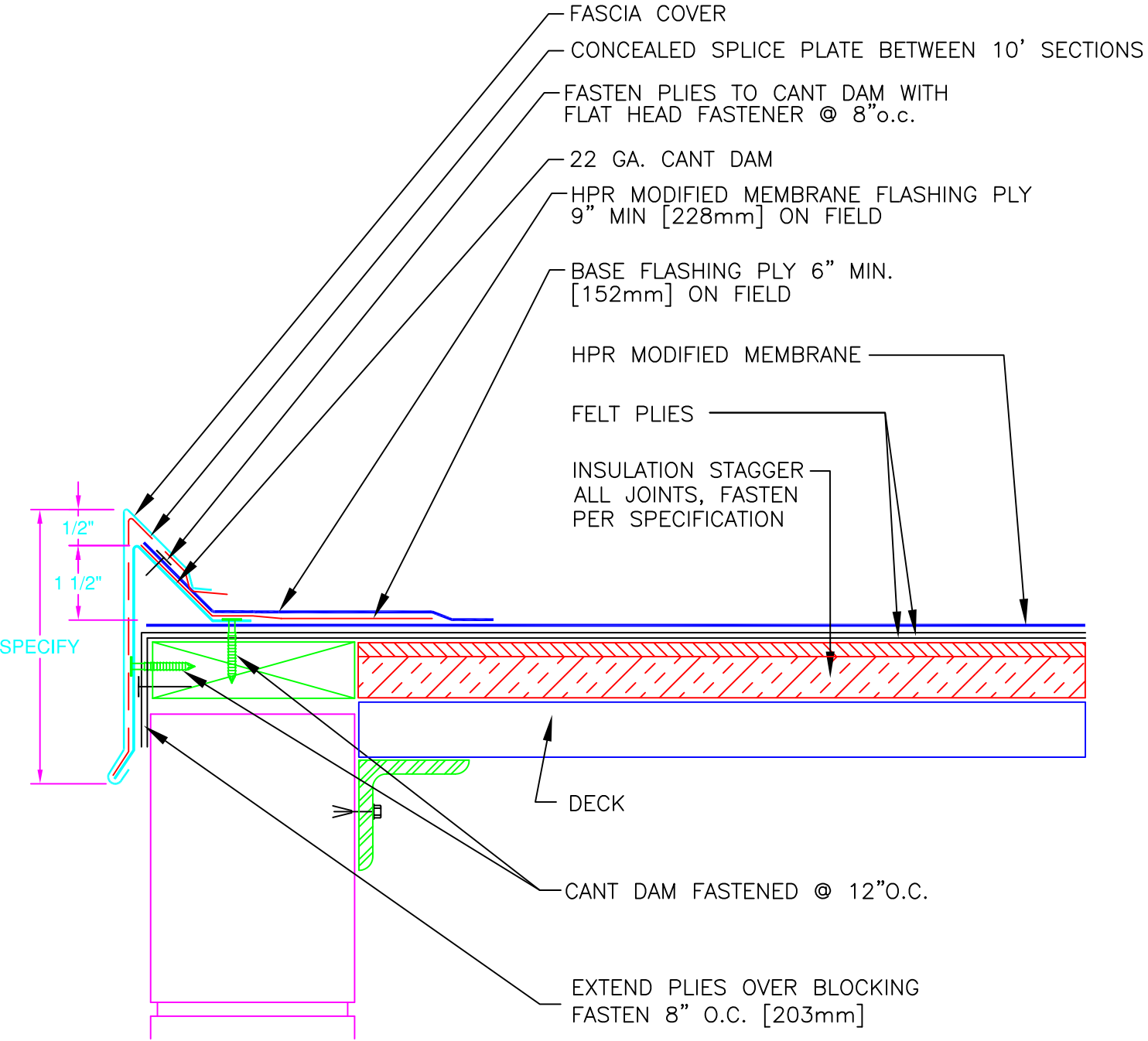

ALL PLIES SET IN BITUMEN SEE SPECIFICATIONS FOR SURFACING



THE GARLAND COMPANY, INC.
GARLAND CANADA, INC.
THE GARLAND COMPANY UK, LTD

DETAIL:

R-MER EDGE FASCIA

GENERIC DECK

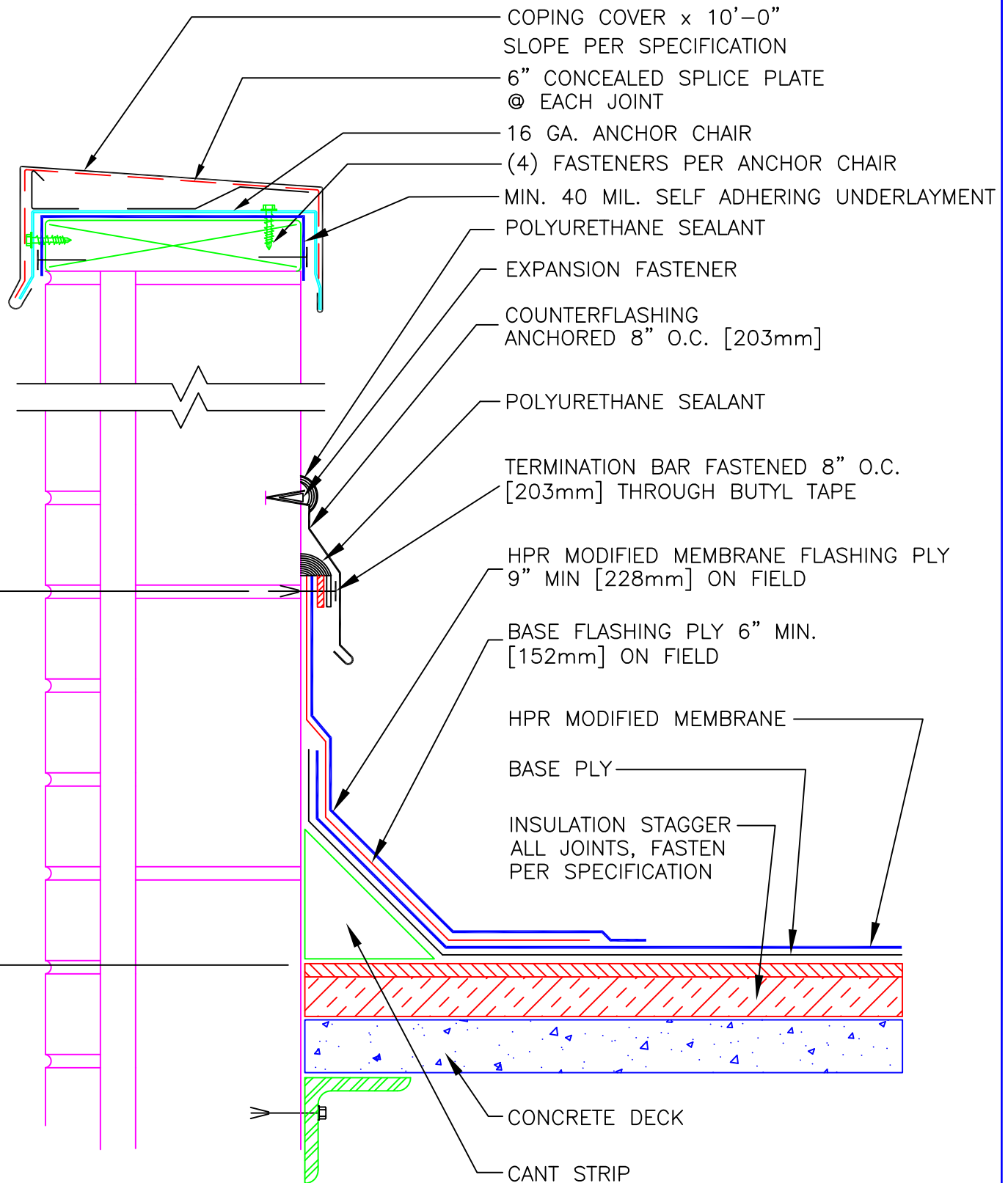

ALL PLIES SET IN MODIFIED COLD ADHESIVE
SEE SPECIFICATIONS FOR SURFACING



THE GARLAND COMPANY, INC.
GARLAND CANADA, INC.
THE GARLAND COMPANY UK, LTD

DETAIL:

REGLET MOUNTED COUNTERFLASHING

2 PLY-COLD APPLIED

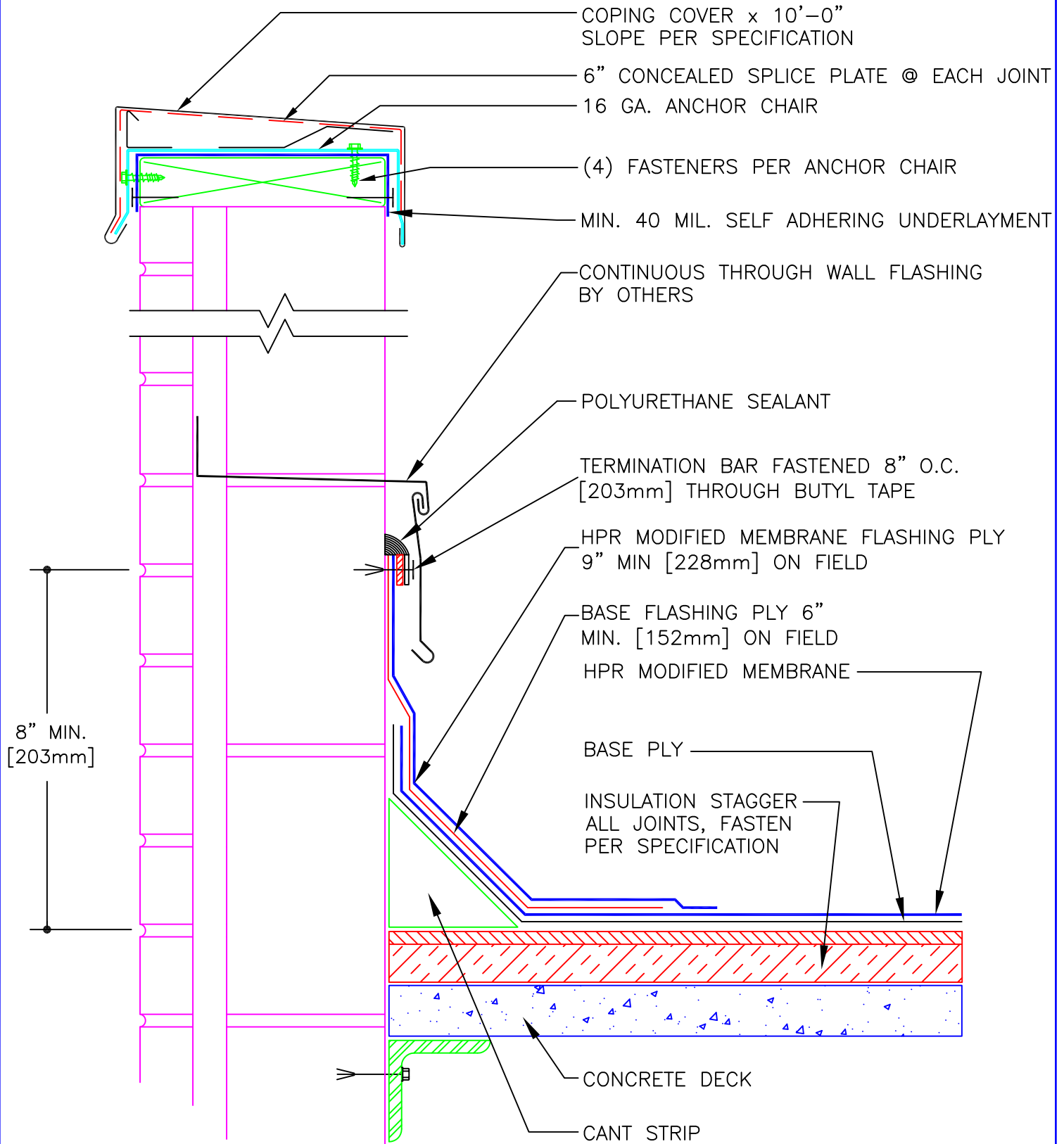

ALL PLIES SET IN MODIFIED COLD ADHESIVE
SEE SPECIFICATIONS FOR SURFACING



THE GARLAND COMPANY, INC.
GARLAND CANADA, INC.
THE GARLAND COMPANY UK, LTD

DETAIL:

THROUGH WALL COUNTERFLASHING

2-PLY-COLD APPLIED

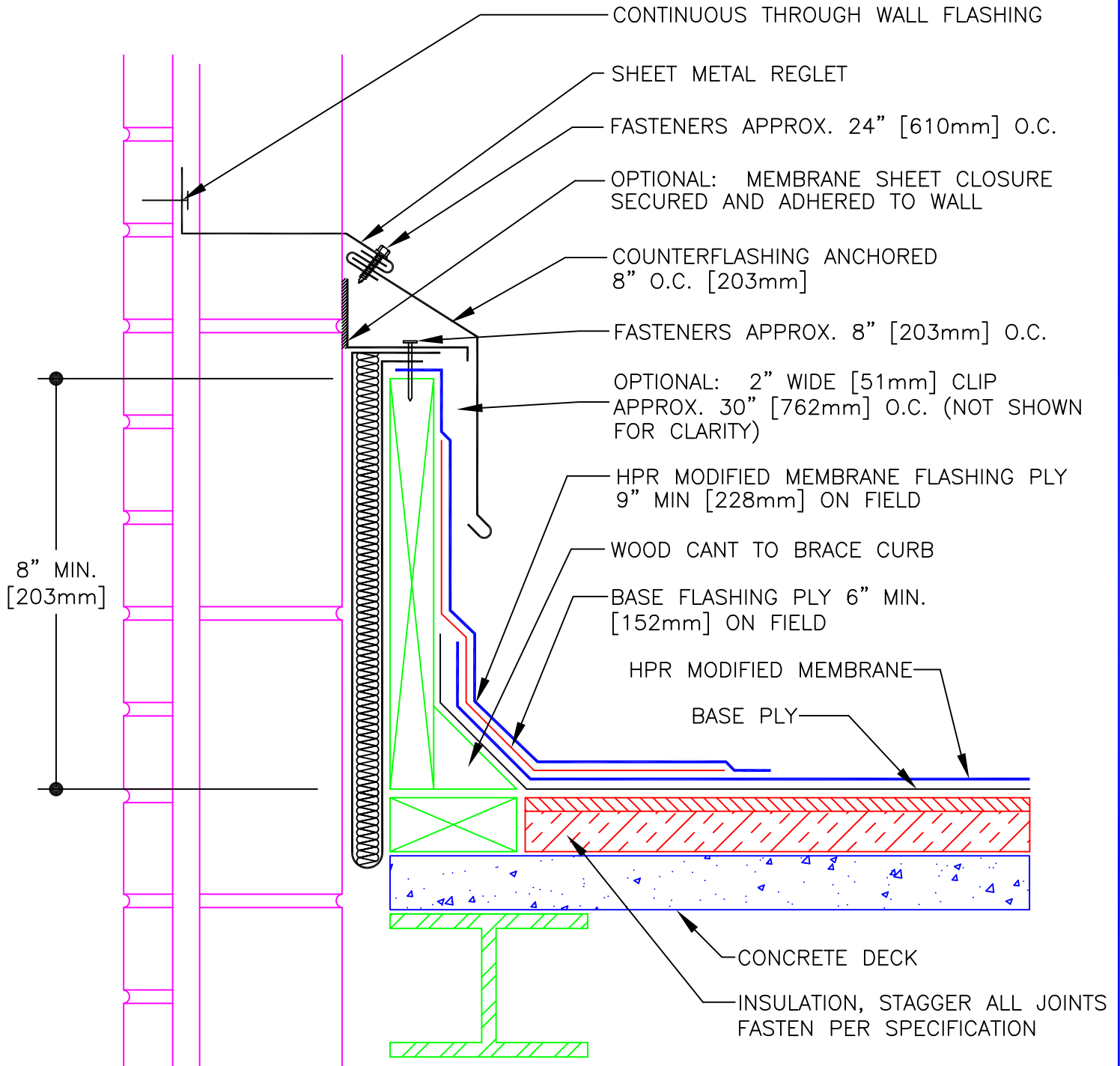

ALL PLIES SET IN MODIFIED COLD ADHESIVE
SEE SPECIFICATIONS FOR SURFACING



THE GARLAND COMPANY, INC.
GARLAND CANADA, INC.
THE GARLAND COMPANY UK, LTD

DETAIL:

BASE FLASHING FOR NON-WALL SUPPORTING DECK

2 PLY-COLD APPLIED

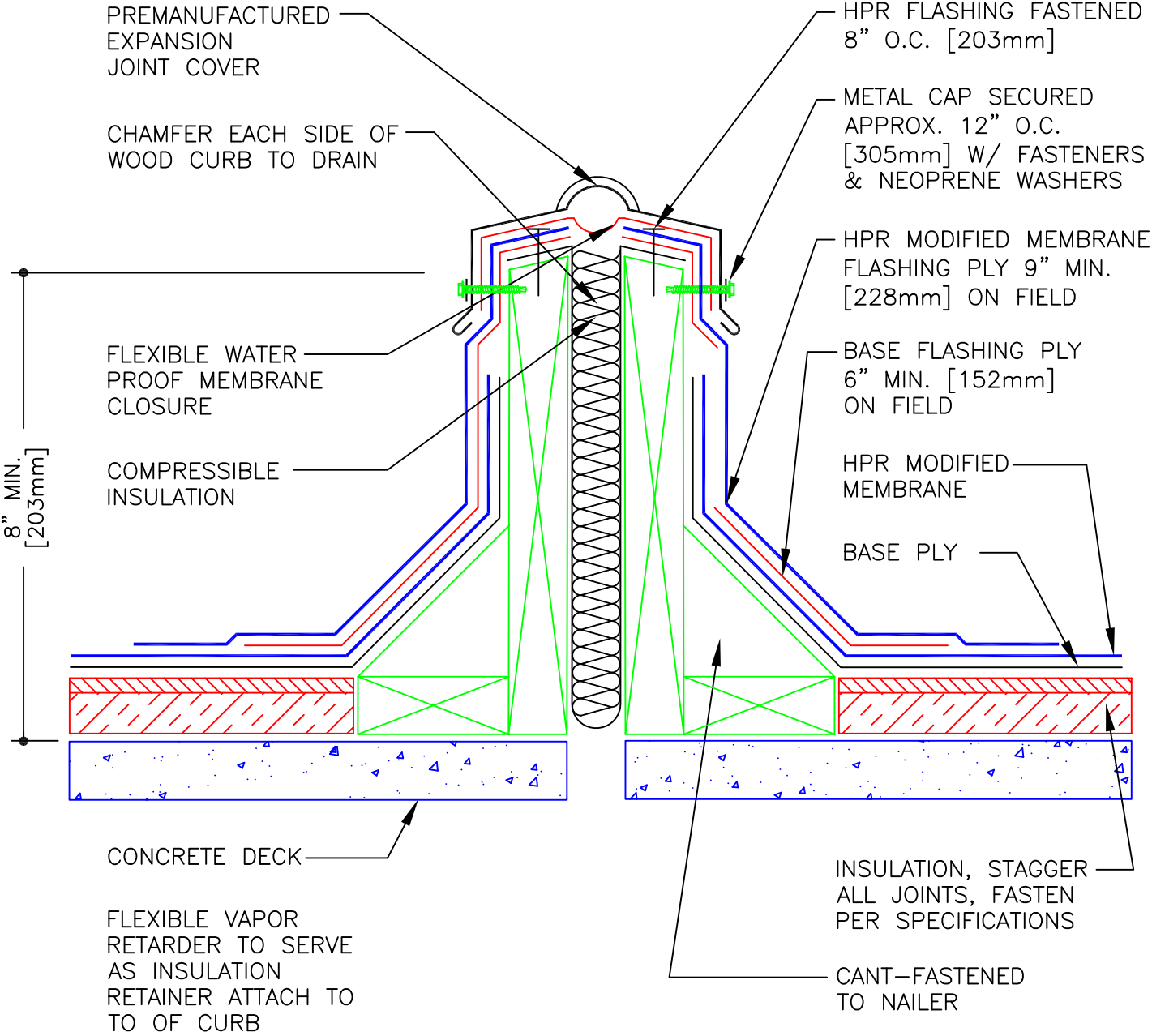

THE GARLAND COMPANY, INC.
GARLAND CANADA, INC.

THE GARLAND COMPANY UK, LTD

DETAIL:

EXPANSION JOINT

2 PLY-COLD APPLIED

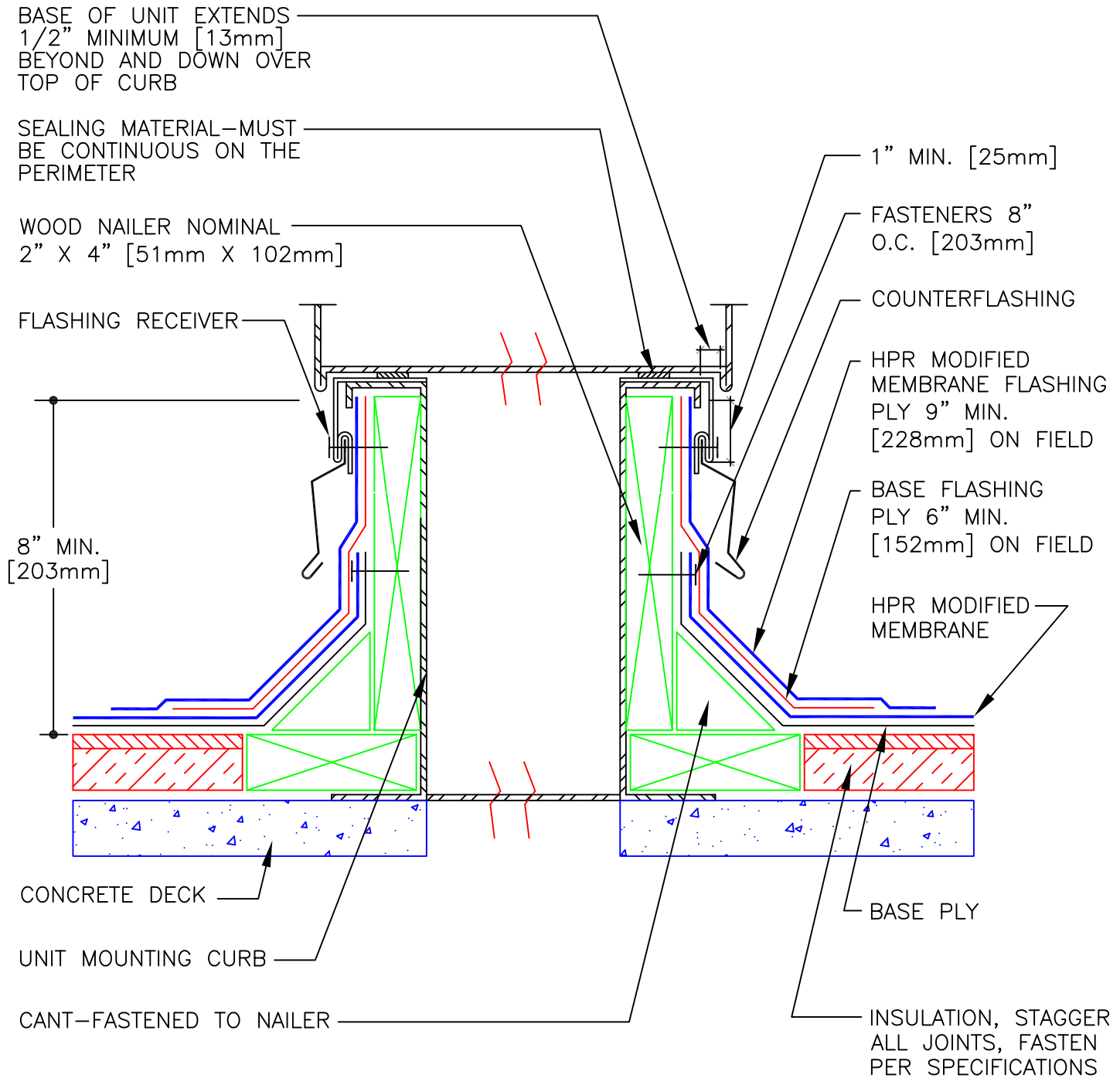

ALL PLIES SET IN MODIFIED COLD ADHESIVE
SEE SPECIFICATIONS FOR SURFACING



THE GARLAND COMPANY, INC.
GARLAND CANADA, INC.
THE GARLAND COMPANY UK, LTD

DETAIL:

CURB DETAIL/AIR HANDLING STATION

2 PLY-COLD APPLIED

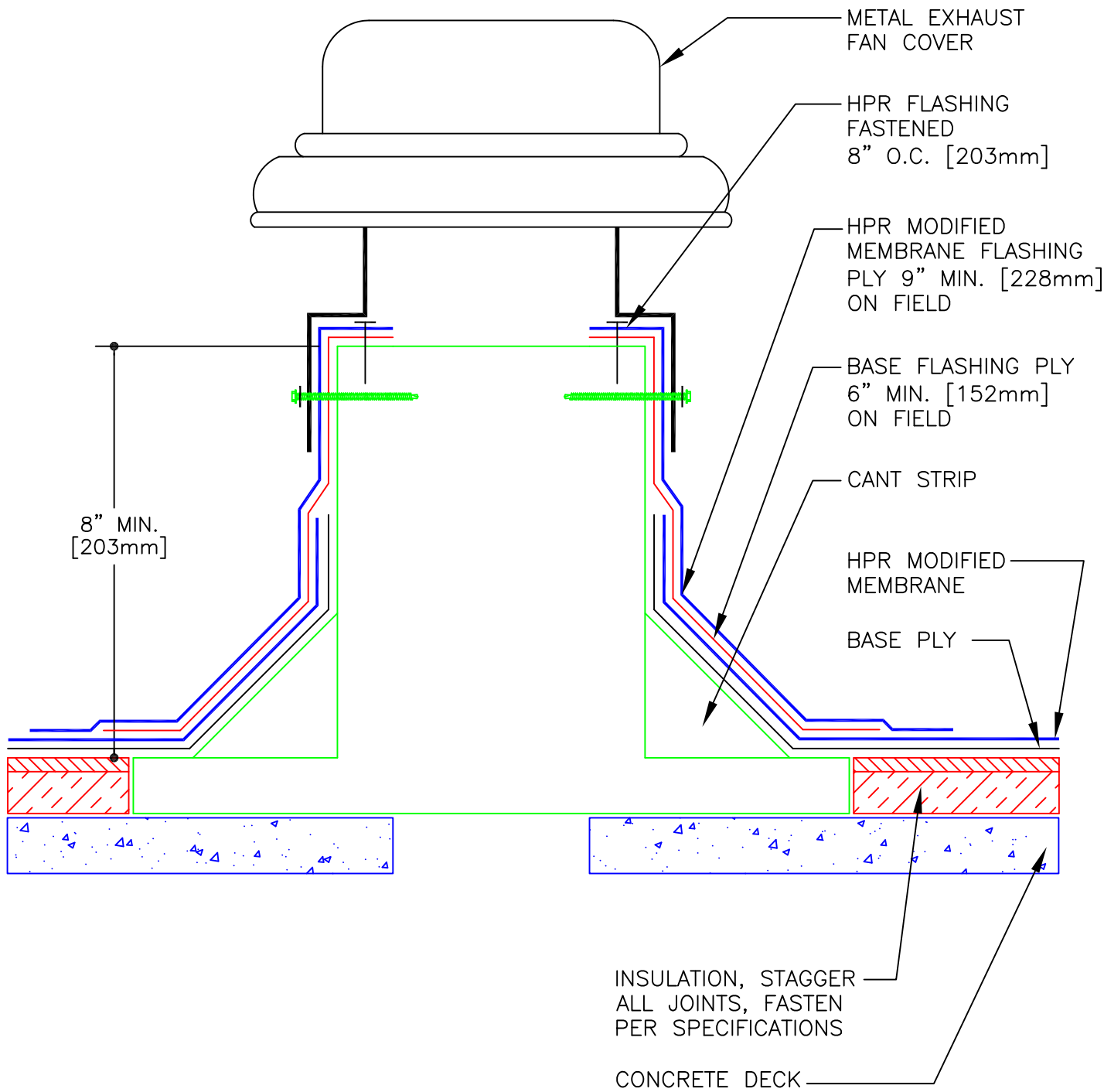

ALL PLIES SET IN MODIFIED COLD ADHESIVE
SEE SPECIFICATIONS FOR SURFACING



THE GARLAND COMPANY, INC.
GARLAND CANADA, INC.
THE GARLAND COMPANY UK, LTD

DETAIL:

EXHAUST FAN DETAIL

2 PLY-COLD APPLIED

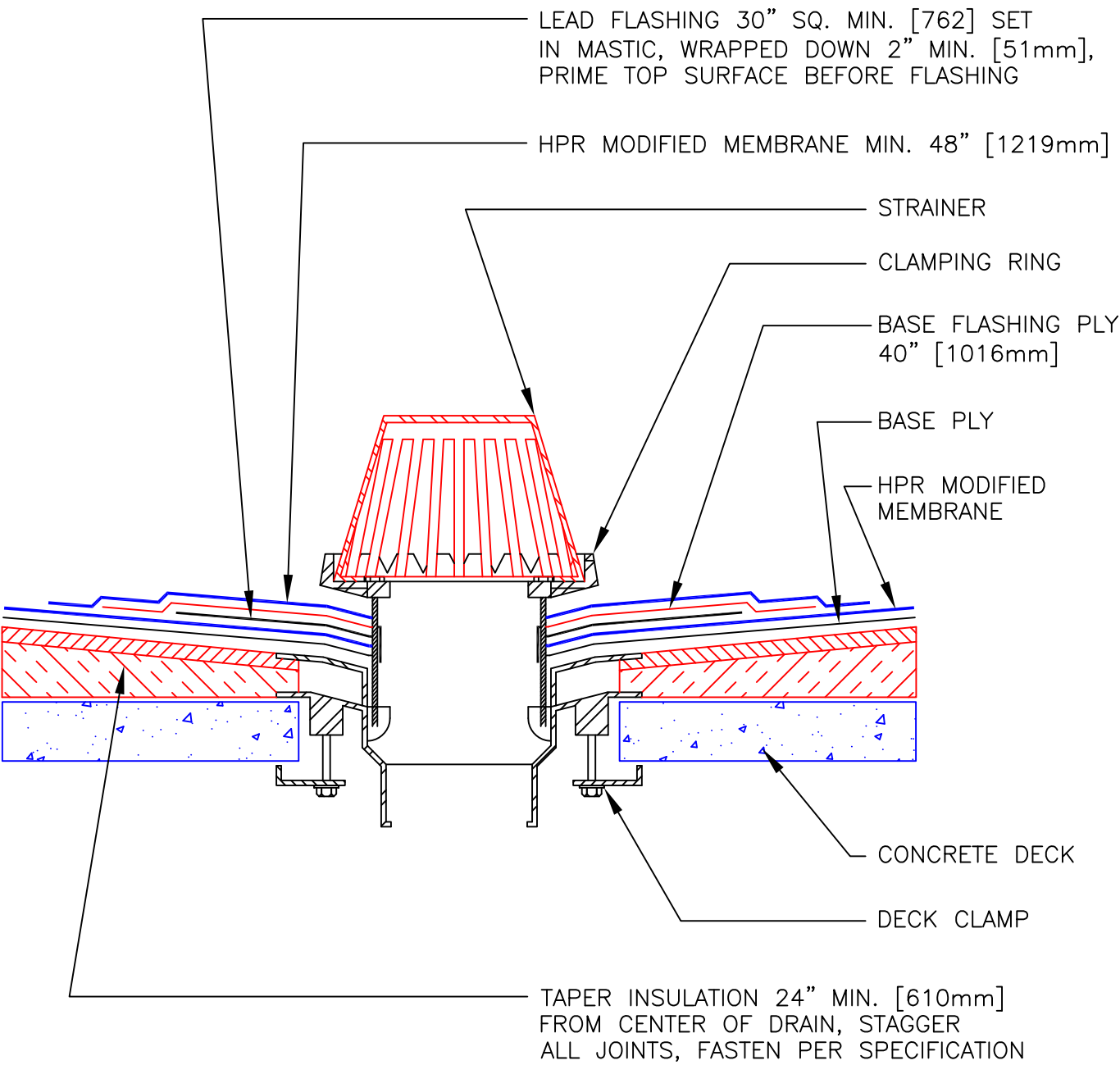

ALL PLIES SET IN MODIFIED COLD ADHESIVE
SEE SPECIFICATIONS FOR SURFACING



THE GARLAND COMPANY, INC.
GARLAND CANADA, INC.
THE GARLAND COMPANY UK, LTD

DETAIL:

ROOF DRAIN

2 PLY-COLD APPLIED

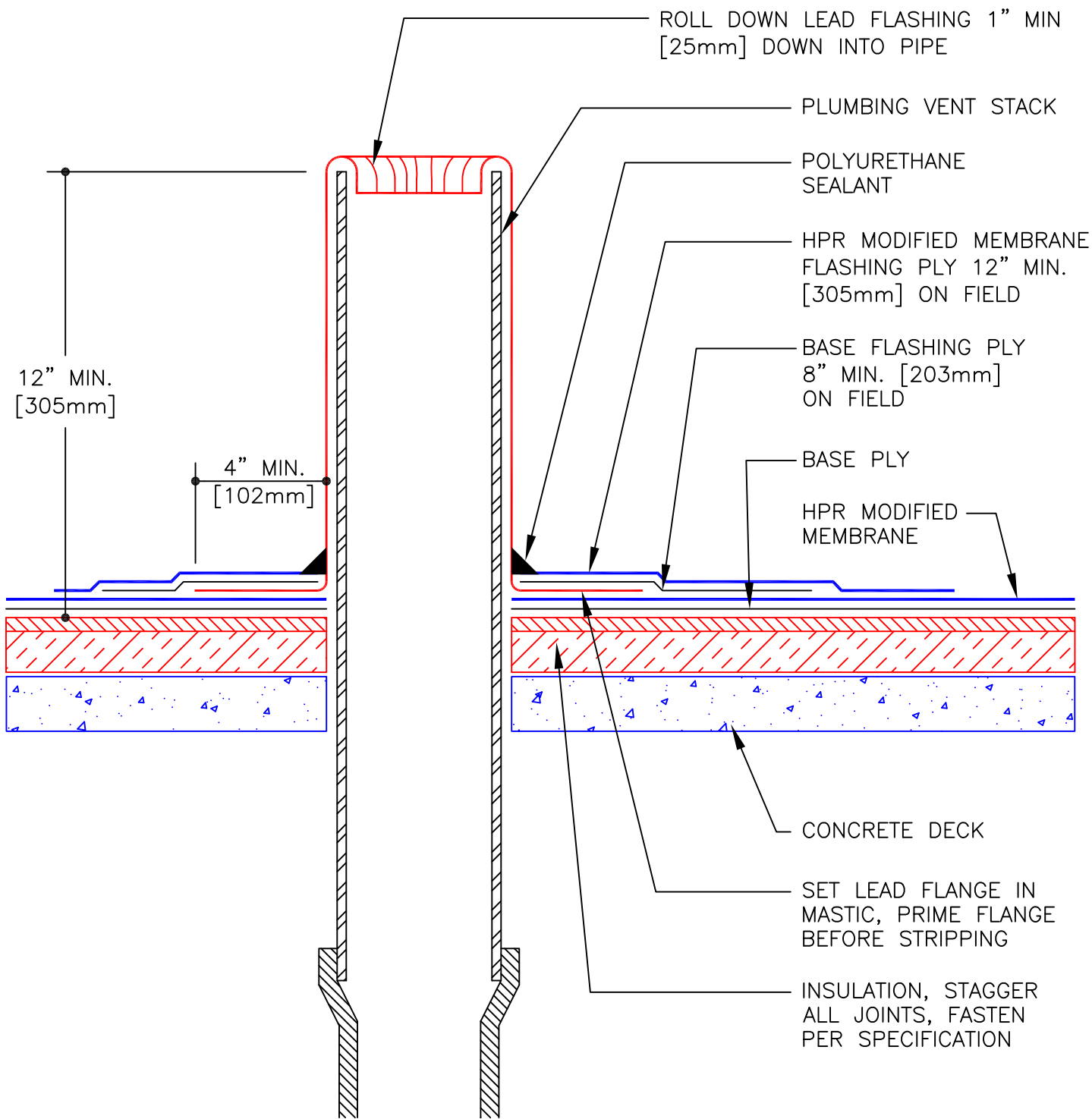

ALL PLIES SET IN MODIFIED COLD ADHESIVE
SEE SPECIFICATIONS FOR SURFACING



THE GARLAND COMPANY, INC.

GARLAND CANADA, INC.

THE GARLAND COMPANY UK, LTD

DETAIL:

PLUMBING STACK

2 PLY-COLD APPLIED

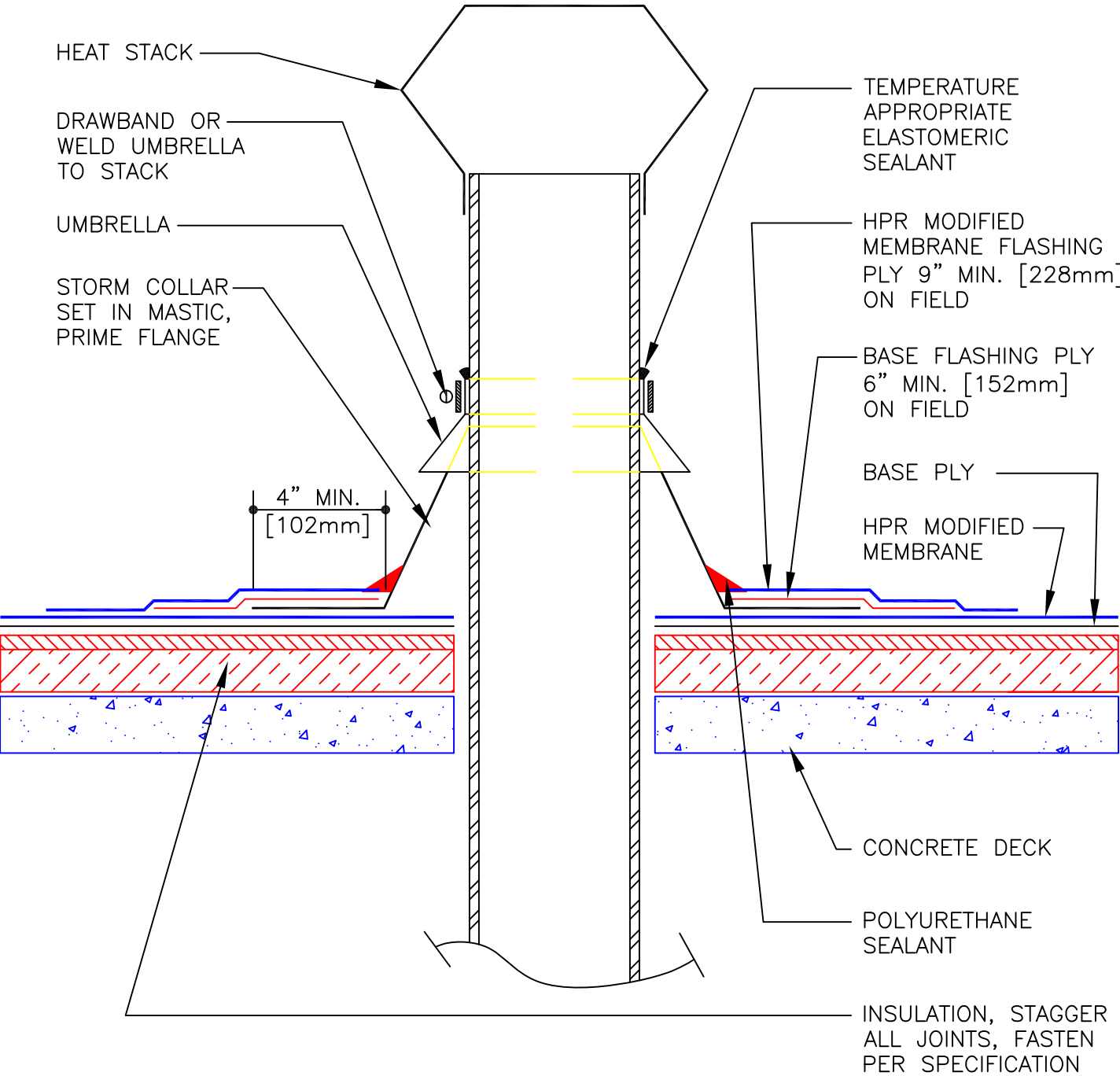

ALL PLIES SET IN MODIFIED COLD ADHESIVE
SEE SPECIFICATIONS FOR SURFACING



THE GARLAND COMPANY, INC.
GARLAND CANADA, INC.
THE GARLAND COMPANY UK, LTD

DETAIL:

HEAT STACK

2 PLY-COLD APPLIED

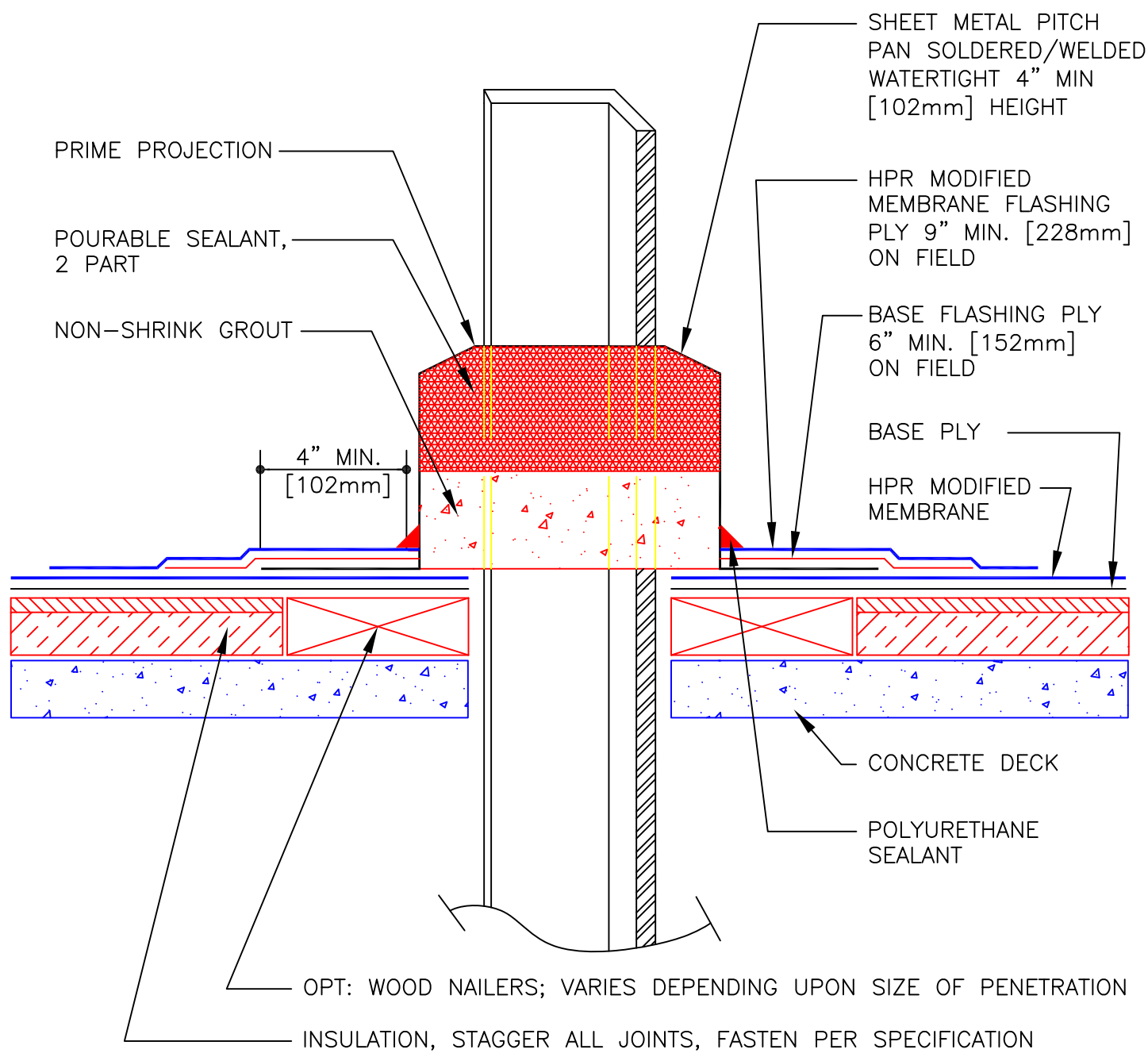

ALL PLIES SET IN MODIFIED COLD ADHESIVE
SEE SPECIFICATIONS FOR SURFACING



THE GARLAND COMPANY, INC.
GARLAND CANADA, INC.
THE GARLAND COMPANY UK, LTD











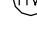

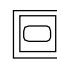

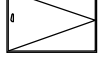

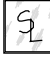
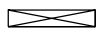

DETAIL:

PITCH POCKET

2 PLY-COLD APPLIED

$$3/8" = 1' - 0"$$

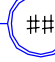
- 1 OPEN / LOW PITCH POCKET FILLER
- 2 RUST DEVELOPING ON VARIOUS COMPONENTS
- 3 BLISTER DEVELOPMENT
- 4 DETERIORATED AND OPEN GRAVEL STOP FLASHING
- 5 IMPROPER DETAILING OF ANTENNA SUPPORT THROUGH ROOF MEMBRANE
- 6 DAMAGED / BROKEN MASONRY
- 7 WET INSULATION

- | | |
|---|-------------------------|
|  | ROOF |
|  | HOT PIPE |
|  | CHIMNEY |
|  | SATELLITE |
|  | ROOF HATCH |
|  | PIPE CONDUIT |
|  | SQUARE VENT |
|  | ROUND AIR DUCT |
|  | STANDARD CURB |
|  | TEST CUT |
|  | SKYLIGHT |
|  | SLEEPER |
|  | ROOF DRAIN |
|  | PLUMBING VENT |
|  | PITCH POCKET |
|  | EXHAUST UNIT |
|  | AIR HANDLING UNIT |
|  | LEAK LOCATION |
|  | DEFICIENCY LOCATION/NO. |
- NOTE: PENETRATIONS ARE APPROXIMATE IN SIZE AND LOCATION TO BE USED AS REFERENCE POINTS ONLY.

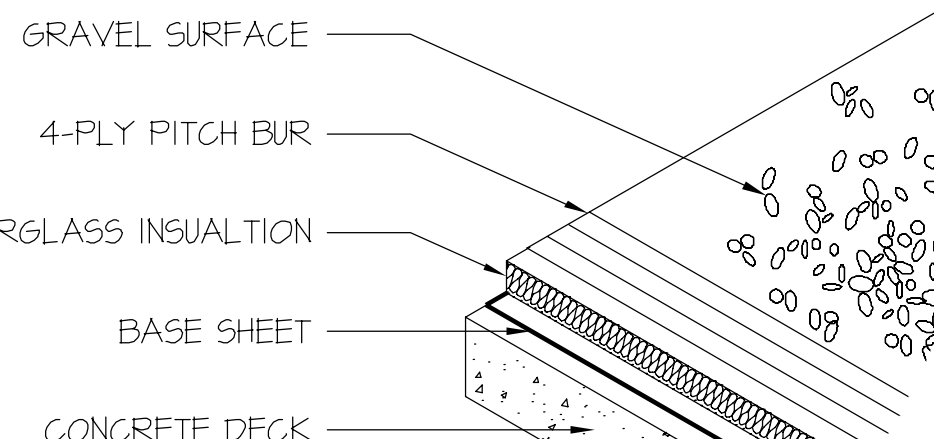

BUILDING 5

The Garland Company, Inc.
94 Mill Street, Unit 302
Somerville, MA 02145
www.GarlandInd.com



DATE:	07/30/2013
DRAWN BY:	1/4"=1'-0"
SCALE:	J.C.W.
CHECKED BY:	J.R.T.

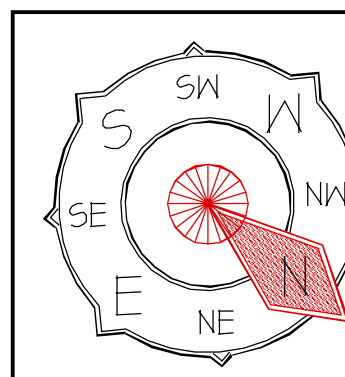

VISUAL ROOF SURVEY
FOR: THE GARLAND COMPANY
PROJECT: CH2M HILL - CITY OF WOONSOCKET
REGIONAL WASTE WATER TREATMENT FACILITY
II CUMBERLAND HILL ROAD, WOONSOCKET, RI
02896

A5

→

Roof System Composition

Layer No	Layer Type	Thickness	Attachment	Condition
1	Concrete Tee's	N/D	Mechically Attached	Good @ Test Cut
2	Base Sheet (vapor barrier)	1 Ply	Mopped in Asphalt	Poor @ Test Cut
3	Polyisocyanurate Insulation	2 Inches	Mopped in Asphalt	Poor @ Test Cut
4	Perlite Insulation	1/2 Inch	Mopped in Asphalt	Poor @ Test Cut
5	Fiberglass Felt Asphalt BUR	3 Plies	Mopped in Asphalt	Poor @ Test Cut
6	Flood Coat & Gravel	N/D	Poured	Fair

→